

7" BOX GUTTER

Seamless

Commercial / industrial

Over 30 different colors to choose from

Available in

Steel - 22 -24 Gauge

Aluminium - 0,32 -0,40

**Adjustable
Flange
Back Profile**



**Straight Back
Profile**

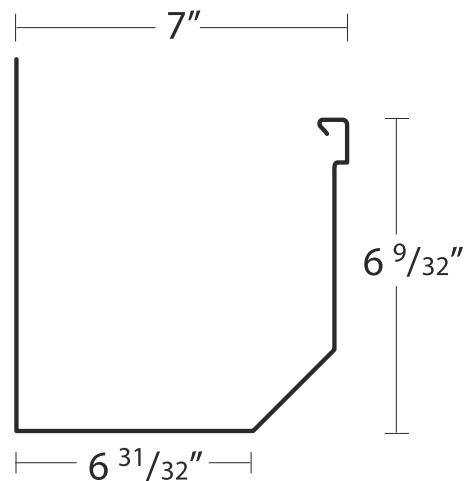
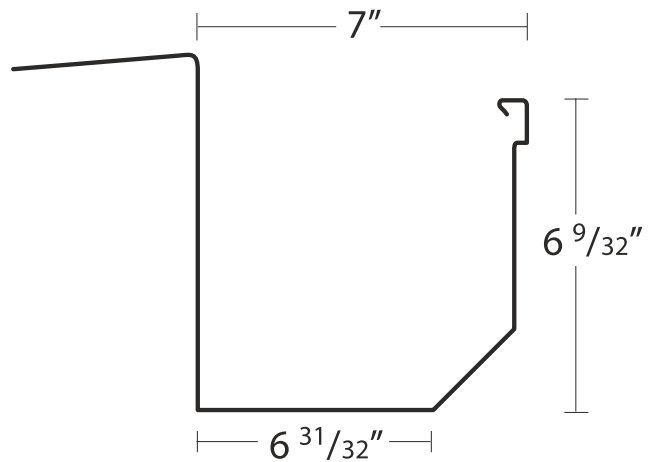

Quick Contact:

609 668 4017 | Office: 609 668 4053

 metaconstructionllc@gmail.com



1226 State Route 94
Blairstown, NJ 07825

I PRODUCT DESCRIPTION

7"Box Gutter Seamless profile is designed for use in commercial and light-industrial applications where an attractive, yet functional, rain-carrying system is required. The large 7" × 6 ¼" trough is capable of handling high volumes of water that are typically found draining from larger commercial roof installations. **This profile can be supplied in up to an .040"-thick painted aluminum or 24-gauge painted steel in long, unbroken lengths.** Depending on local rainfall calculations you can drain the 7"Box Gutter Seamless system with either heavy-duty 3" × 4" downspouts or heavy-duty 4" × 5" downspouts supplied in the same color as the gutter or field-sprayed to match. The 7"Box Gutter Seamless is available with a straight back or with the Alcoa-style free-float hook. Section splice plates, end caps and corners are to be custom-fabricated of the same material and finish as that of the gutter.

II TECHNICAL DATA

Meta Construction 7"Box Gutter Seamless, although only 1" larger than the typical 6" Ogee gutter, is capable of handling up to eighty-one (81) gallons per minute at a 1/8"-per-foot slope and one hundred fifteen (115) gallons per minute at a ¼"-per-foot slope. The 6" gutter, in comparison, will only carry fifty-seven (57) gallons per minute and eighty (80) gallons per minute respectively. For complete flow charts, rainfall intensity, drainage factors and expansion calculations see the latest edition of the Sheet Metal and Air Conditioning Contractors Manual, Chapter #1, Roof Drainage Systems.

III MATERIAL / FINISHES

A. Gutters shall be seamless and continuous, with no end laps, roll-formed out of 3105-H24 aluminum alloy (minimum tensile strength 26 000 psi, minimum yield strength 25 000 psi) or equivalent, up to .040" thick, or 24-gauge Galvalume® (ASTM-A-792) minimum yield strength 50 000 psi.

B. Gutter downspouts (leaders) shall be aluminum 4" × 5" or 3" × 4" (select one, as appropriate) or 24-gauge steel, custom-fabricated.

C. End caps shall be .032" aluminum or 24-gauge steel, custom-fabricated.

D. Inside and outside miters shall be .032" aluminum or 24-gauge steel, custom-fabricated.

E. Downspout anchors shall be made of the same material and color as the downspouts and installed every 60".

F. Gutter hangers shall be specially designed support brackets installed at 24" o.c. maximum.

Aluminum – Polyester Paint Finish. Prior to painting, the metal shall receive a pretreatment to assure maximum paint adhesion. The exterior finish shall be CastleClad®, a two-coat system applied in a continuous baked-on process in a single operation, comprising an acid-based primer and a baked-on high-performance linear polyester topcoat. The inside of the gutter shall be finished with a polyester backer or wash coat. All exposed accessories used with the Meta construction 7"Box Gutter Seamless System shall have the same CastleClad finish as the gutters.

Steel – Kynar® Finish. PermaColor 3500 is applied as an .8–.9 mil full-strength 70 % Kynar 500® fluorocarbon (Polyvinylidene fluoride PVF₂) coating over a urethane primer of .2–.3 mil on the finish side, with primer and a wash-coat on the reverse on steel, or with just a wash-coat on aluminum.

VI. WARRANTY

7"Box Gutter Seamless System shall be covered by a Limited 20-Year pro-rated Finish Warranty in a polyester finish or a Limited 35-Year non-prorated Finish Warranty in a Kynar® finish. Contractor/Installer shall provide installation-warranty coverage of the actual installation under separate agreement.

V. GUTTER COLOR CHART

